

INSTALLATION INSTRUCTIONS

SAFER-BR-600

TO FIT BREEZY/SUNRISE WHEELCHAIR MODEL:

Breezy 600



IMPORTANT! Please read the *entire* installation packet and review *all* pictures before starting installation.

INSTALLATION VIDEOS ARE AVAILABLE ON OUR WEBSITE AT
www.saferwheelchairs.com

Safer Automatic Wheel Lock Kit

1 General

Check all parts for shipping damage. In case of damage, DO NOT use. Contact Carrier/UPM for further instructions. To ensure the safe installation of the Safer Automatic Wheel Lock Kits, these instructions must be followed.

For Installation/Technical assistance please call 601-353-3193 ext. 215, Monday - Friday 8:00 AM-5:00 PM CST

1.1 Symbols

Signal words are used in this manual and apply to hazards or unsafe practices which could result in personal injury or property damage. See the information below for definitions of the signal words.



WARNING

Warning indicates a potentially hazardous situation which, if not avoided, could result in death or serious injury.

CAUTION

Caution indicates a potentially hazardous situation which, if not avoided, may result in property damage or minor injury or both.



Gives useful tips, recommendations and information for efficient, trouble-free use.

1.2 Overview



WARNING

DO NOT use this product or any available optional equipment without first completely reading and understanding these instructions and any additional instructional material such as owner's manuals, service manuals or instruction sheets supplied with this product or optional equipment. If you are unable to understand the warnings, cautions or instructions, contact a healthcare professional, dealer or technical personnel before attempting to use this equipment - otherwise, injury or damage may occur.

This procedure **MUST** be performed by a qualified technician.

After any adjustments, repair or service and before use, make sure all attaching hardware is tightened securely - otherwise injury or damage may result.



WARNING

Sloped Surfaces: Always engage the wheelchairs manual locks while seated on any type of sloped surface. Safer Locks are not designed to engage while the wheelchair is occupied.



WARNING

The intended use of Safer Automatic Wheelchair Wheel Locks is to safe guard against unintended wheelchair roll while transferring to and from the wheelchair in the event that the manual locks are not engaged. Safer Locks are not a manual lock replacement.

CONTINUE TO USE YOU WHEELCHAIRS MANUAL LOCKS AS NORMAL.

2 Safer Automatic Wheel Lock General Overview



Tools Required - Flat Head Screwdriver, Phillips Screwdriver, Socket Wrench Set, Rubber Hammer (Allen Wrench included).

2.1 Parts Supplied



Check that you receive all parts listed and for any damage to parts during shipping. In case of damage, DO NOT USE. Contact Carrier/UPM for further instructions



2.2 Wheelchair Height Settings

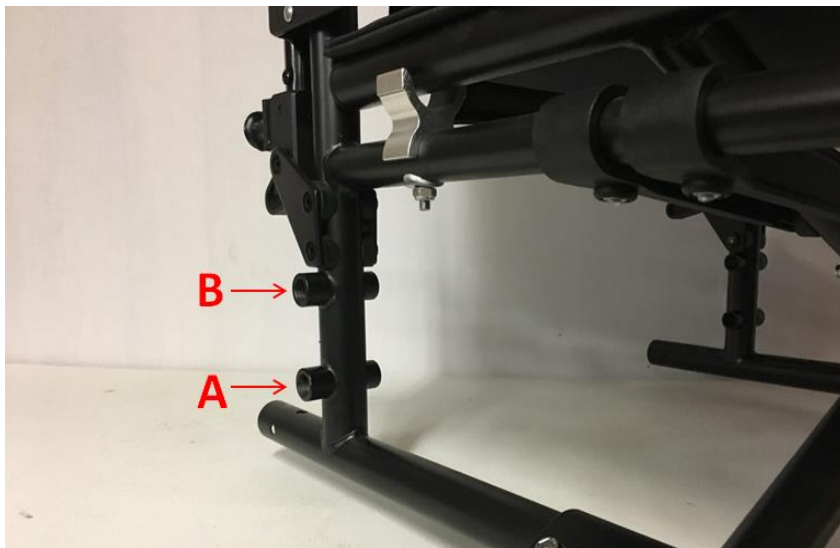

A: Standard/Adult Height: Typically sets seat 19.5" from floor.

B: Hemi Height: Generally two to three inches lower than Standard/Adult Height, allows the seated user to easily propel their wheelchair with their feet.

2.3 Lock Pin Assembly Breakdown

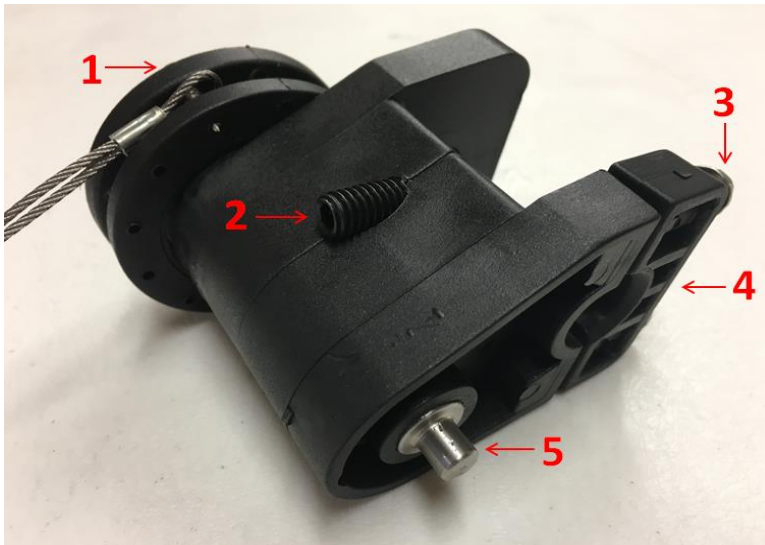

- 1: Lock Pin Assembly Cable Guide
- 2: Set Screw
- 3: Mounting Screw (2 per side)
- 4: Clamp
- 5: Lock Pin

2.4 Paddle Assembly Breakdown

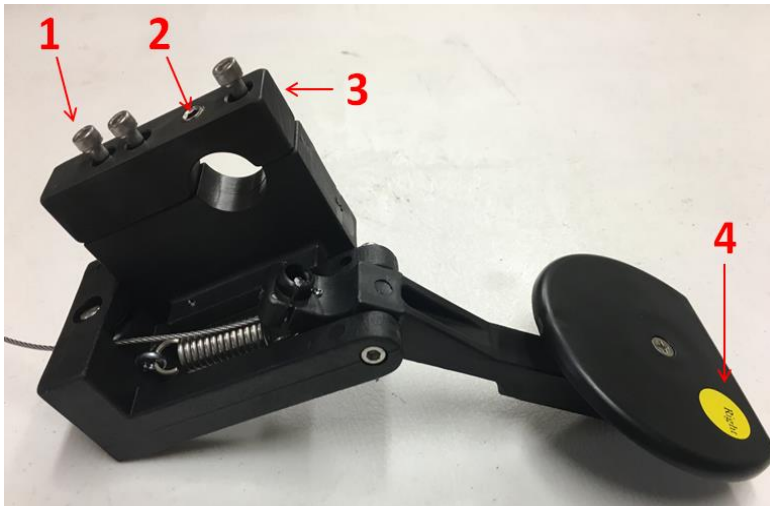

- 1: Mounting Screws (3 per side)
- 2: Set Screw
- 3: Clamp
- 4: Left/Right Label

2.5 Override Assembly Breakdown

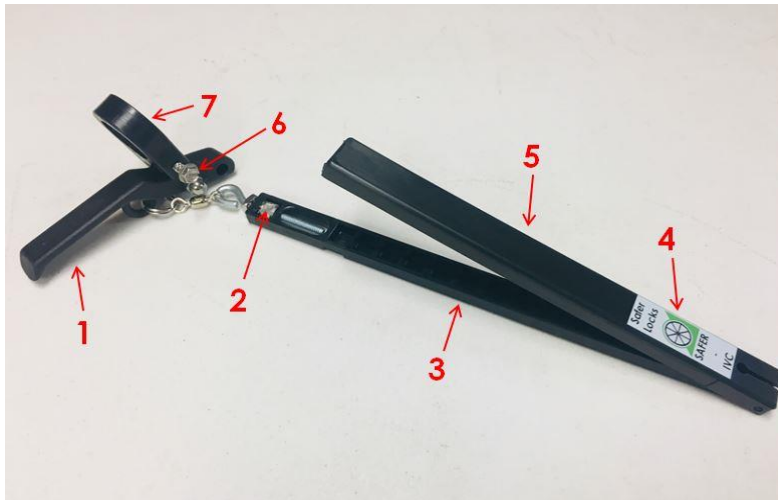

- 1: Override Handle
- 2: Override Fine Tune Adjuster
- 3: Override Assembly Adjuster
- 4: Kit Model
- 5: Adjuster Cover
- 6: Clamp Screw
- 7: Override Handle Clamp

3 Installation



If not using a **Safer Wheelchair Service Stand** (pg. 14), securely block up the wheelchair frame so that the rear wheels do not touch work surface and the wheels rotate freely.



As Pre-Assembled - Locks are labeled LEFT & RIGHT as if you were sitting in the chair. (2.4-4)
Your Safer Automatic Wheel Lock Kit is preset for installation at the Adult Height. (2.2)

3.1 Installing the Lock Pin Assembly on Breezy 600 with **THREADED AXLES** (See 3.2 for Quick Release Axles)

1. Take off the rear wheels by removing the outside and inside nuts on the Axle Bolt. Slide the Axle Bolt out once both nuts have been removed. **KEEP THE AXLE BOLT**
Discard the Nuts and Washers. Replacements are supplied in your Safer Automatic Wheel Lock Kit.
2. A. Remove Mounting Screws (2.3-3) and Clamp (2.3-4) from Lock Pin Assembly and loosen Set Screw (2.3-2) in the center of the Lock Pin Assembly.
B. Remove Mounting Screws (2.4-1) and Clamp (2.4-3) from Paddle Assembly and loosen Set Screw (2.4-2) in the center of the Paddle Assembly Clamp (2.4-3).
3. With the Set Screw facing the front of the wheelchair, position the Lock Pin Assembly over the Axle Hole on the wheelchair.
4. From the outside, slide the Axle Bolt through Lock Pin Assembly and Axle Hole. (Fig. 3)
5. Make sure that the Set Screw is backed out enough to rotate the Pin Assembly up and down if the two black nuts on the axle plate are in the way on the next step
6. Using the two Mounting Screws and Clamp (2.3-3), secure the Lock Pin Assembly to the wheelchair frame. Clamp must be mounted flush with the Lock Pin Assembly. (Fig. 4)
7. Tighten the Set Screw until it touches the frame and the Pin Assembly is in a fixed position. (Fig. 5)
(Do not overtighten. Stop once Set Screw touches frame)
8. Place the smaller nut that was supplied with your kit onto the inside axle and tighten. (Fig.6)

Fig.3



Fig. 4



Fig. 5



Fig. 6



3.2 Installing the Lock Pin Assembly on Breezy 600 with **QUICK RELEASE AXLES**

1. Take off the rear wheels by removing the Quick Release Bolt.
DISCARD the Quick Release Axle Bolts. Replacement Axle Bolts are provided with your Safer Lock Kit.
2.
 - A. Remove Mounting Screws (2.3-3) and Clamp (2.3-4) from Lock Pin Assembly and loosen Set Screw (2.3-2) in the center of the Lock Pin Assembly.
 - B. Remove Mounting Screws (2.4-1) and Clamp (2.4-3) from Paddle Assembly and loosen Set Screw (2.4-2) in the center of the Paddle Assembly Clamp (2.4-3).
3. With the Set Screw facing the front of the wheelchair, position the Lock Pin Assembly over the Axle Hole on the wheelchair.
4. From the inside of the wheelchair, slide the supplied Axle Bolt through the Pin Assembly and Axle Hole. (Fig. 7)
5. Make sure that the Set Screw is backed out enough to rotate the Pin Assembly up and down if the two black nuts on the axle plate are in the way on the next step
6. Using the two Mounting Screws and Clamp (2.3-3), secure the Lock Pin Assembly to the wheelchair frame. Clamp must be mounted flush with the Lock Pin Assembly. (Fig. 8)
7. Tighten the Set Screw until it touches the frame and the Pin Assembly is in a fixed position. (Fig. 9)
(Do not overtighten. Stop once Set Screw touches frame)

Fig. 7



Fig. 8

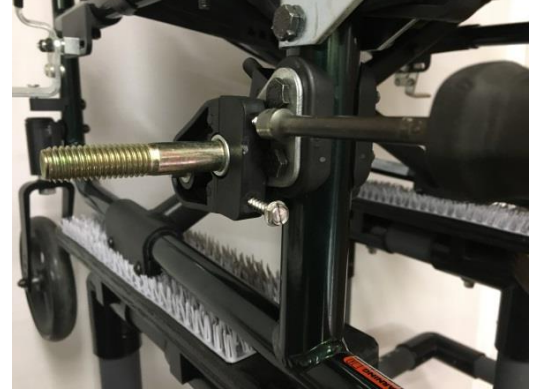

Fig. 9



3.3 Installing the Override Pulley

1. Remove and **DISCARD** the 7/16 Nut and Bolt holding the back of the flipback arms to the frame. (Fig.10)
2. Slide the supplied Bolt back through the arm bracket. (Fig. 11)
3. Slide the Idler Bushing onto the Bolt with the larger end against the frame. (Fig. 12)
4. Slide the Idler Pulley over the Bushing, followed by the Washer and Nut then tighten. (Fig. 13)

Fig. 10



Fig. 11



Fig. 12



Fig. 13



3.4 Installing the Override Assembly

1. Back the Handle Clamp Screw out enough to separate the two sides of the Clamp.
2. Run the Cable from the top of the Cam Wheel and under the Pulley as shown in red (Fig. 14)
3. Open the Adjuster Cover to give enough slack in the Cable for the Handle Clamp to reach the wheelchair handle. Spread the Clamp and position onto the handle of the wheelchair. (Fig. 15)
4. Tighten the Clamp Screw. (Fig. 16)
5. Insert the cable end into the appropriate slot in the Override Adjuster and close the cover. (Fig. 17)
6. When the Handle is pulled and just touching the bottom, the Lock Pin should fully disengage into the Lock Pin Assembly.
7. Fine adjustments are made by loosening the square nut at the top of the Override Adjuster and turning the round knurled nut to either tighten or loosen the handle.
8. Once all adjustments have been made, **TIGHTEN** the square nut.

Fig. 14

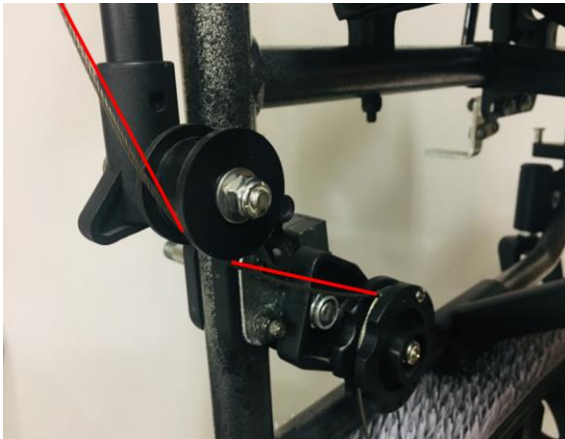

Fig. 15



Fig. 16



Fig. 17



3.5 Installing the Paddle Arm Assembly

1. Wrap Paddle Arm Assembly cable under the Lock Pin Assembly Cable Wheel and mount under the seat of the wheelchair. (Fig. 18)
2. Using the three Mounting Screws (2.4-1) and Clamp (2.4-3), install the Paddle Arm Assembly to the upper bar of the wheelchair frame between the rear seat H-block and the center cross brace. (Fig.19) Thread Screws through Clamp into the Paddle Arm Assembly, but **DO NOT** completely tighten the Clamp at this point.
3. Move the Paddle Arm Assembly back and forth until Cable is at the correct tension. Correct cable tension should have approximately 1" of slack in the cable.
4. Paddle Arm Assembly **MUST** be vertically level to get the proper cable tension and for the Locking system to work properly. (Fig. 20)
5. After Paddle Arm Assembly is vertically level and the cable is at the proper tension, secure the Paddle Arm Assembly by tightening the three Mounting Screws and the center Set Screw. (Fig. 21 & Fig. 22)
6. Repeat STEPS 1 - 5 to install other side of the Paddle Arm Assembly.

Fig. 18

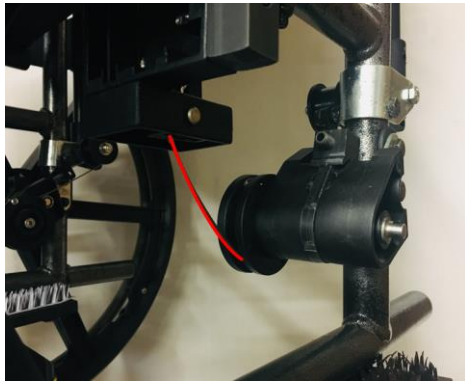

Fig. 19



Fig. 20



Fig. 20



Fig. 21



3.4 Installing the Wheel Locking Hub

1. Line the spoke grooves on the Wheel Locking Hub with the spokes on the wheel. Using a rubber hammer (Fig. 21), tap the Wheel Locking Hub onto the wheel **making sure the Hub is flush and level with wheel.** (Fig. 22) Repeat to install the other side of the Wheel Locking Hub.

Fig. 21



Fig. 22

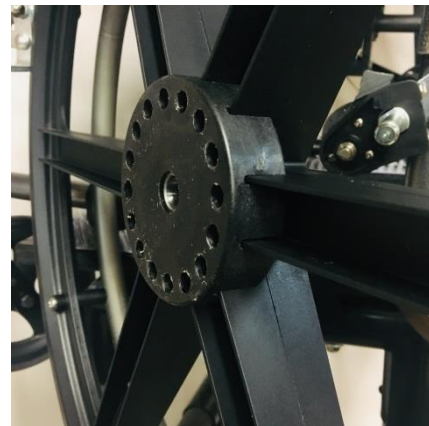

3.5 Reinstalling the Rear Wheel

1. Slide 1 of the 2 Metal Spacers supplied with your kit onto the Axle Bolt. (Fig.23)
2. Slide 1 of the 2 **** Black Washers **** onto the Axle Bolt flush with the Pin Assembly. (Fig. 24)
**** RED WASHER ARE SHOWN FOR CONTRAST IN PICTURE ****
3. Slide the wheel onto the Axle Bolt and turn until the Lock Pin fits into one of the holes on the Hub. (Fig. 25)
4. Tighten the Axle Nut using a 3/4 socket until snug. If the wheel does not freely spin, back off the nut a quarter turn at a time.

Fig. 23



Fig. 24

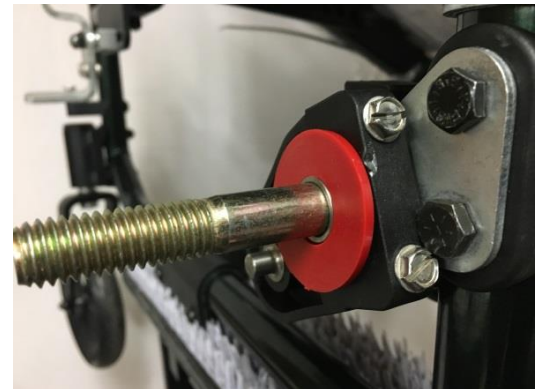

Fig. 25



Fig. 26



4 TESTING

4.1 Testing to ensure Safer Automatic Wheel Lock Kits are installed correctly

1. Before removing chair from work stand, press the Override Assembly Handle (2.5-1) and release while turning the wheel. You will need to do this to ensure the Lock Pin Assembly Pin pops into all 16 holes in the Wheel Locking Hub. **Do this on both sides of chair.**



If Lock Pin Assembly Pin (2.3-5) does not pop into ALL 16 holes of the Wheel Locking Hub, loosen or tighten the Lock Pin Assembly Set Screw (2.3-2). If the Set Screw is too tight, this can cause the Lock Pin Assembly to become out of line.



To adjust the Lock Pin Assembly Pin: While holding pressure on pin with wheel, using a 7/16 wrench, adjust nut to increase or decrease pin clearance. (Fig. 27)

Fig. 27



Fig. 28



2. When pressing the Override Assembly Handle, make sure the Lock Pin Assembly Pin is retracted enough so the pin will not touch the Wheel Locking Hub. You can make fine adjustments by adjusting the eye bolt on top of the Override Assembly Adjuster. (2.5-2 and Fig. 28)

4.2 Testing by USING the Safer Automatic Wheel Lock Kits.

1. Remove chair from work stand. Sit in and stand out of chair multiple times to ensure the Safer Automatic Wheel Locking system is working properly.

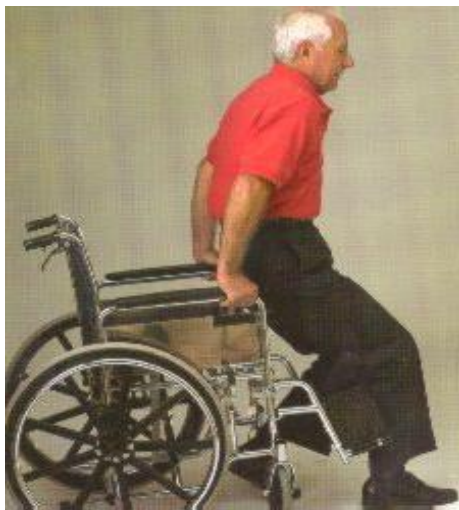







CAUTION

Use caution when sitting and standing from wheelchair while testing. If the Safer Automatic Wheel Lock system fails, it has been designed to fail in the LOCKED position. However if the Safer Automatic Wheel Lock Kit is not installed properly, the Lock Pin Assembly may not lock into the Wheel Locking Hub. Follow all the Safety Guidelines in the Wheelchairs Owners Manual.



If The Safer Automatic Wheel Lock system does not work properly after troubleshooting, Contact UPM/Manufacture for further instructions.

5 KIT FIT LIST

INVACARE	Kit Number	Seat Width	Back Height
Tracer EX2	SAFER-IVC	16"-20"	16"
Tracer SX5	SAFER-IVC	16"-22"	16"-18"
9000 SL	SAFER-IVC	16"-20"	ADJ
9000 XT (Dual Axle Frame) *	SAFER-IVC	16"-22"	ADJ
9000 XDT	SAFER-IVC	16"-22"	ADJ
Tracer SX5 Recliner	SAFER-IVC-RC	16"-22"	34"
Tracer IV	SAFER-IVC-T4	18"-24"	16"
9000 XT (Super Hemi Single Axle) **	SAFER-IVC-SL	16"-18"	ADJ
* Will not fit 9000 XT Recliner ** 9000 XT Super Hemi <u>must</u> have Space Saver Arms			
MEDLINE			
Excel Narrow	SAFER-MED	16"	16"
Excel 2000	SAFER-MED	18"	16"
Excel Wide (300lb. Cap)	SAFER-MED	20"	16"
Excel K3 Lightweight	SAFER-MED	16"-18"	16"
Excel K4 Lightweight 	SAFER-MED-K4	16"-20"	ADJ
BREEZY			
Breezy Ultra 4 * 	SAFER-BR-U4	16"-20"	ADJ
Breezy 600 *	SAFER-BR-600	16"-20"	ADJ
* Will not fit Breezy Ultra 4 or Breezy 600 Ultra Hemi			
NOVA			
5000 Series 	SAFER-NOVA	16"-20"	16"
DRIVE			
Viper Plus GT 	SAFER-DRV-GT	16"-22"	16"
Cruiser III 	SAFER-DRV-C3	16"-20"	16"
Silver Sport 2 	SAFER-DRV-SS2	16"-20"	16"
Sentra EC	SAFER-DRV	20"-22"	16"

Safer Wheelchair Service Stand

EASIER & SAFER: DESIGNED TO SAFELY HOLD WHEELCHAIRS AT THE PERFECT HEIGHT FOR ALL MANUAL WHEELCHAIR SERVICE AND REPAIR, INCLUDING SAFER LOCK INSTALLATIONS

SIMPLE, FUNCTIONAL, LIGHTWEIGHT, PORTABLE & DURABLE

- Adjustable Width fits Wheelchairs from 16"-24" wide
- Sets Wheelchair Axles 37" from floor
- Overall Footprint of 36" x 35" with Leg Extensions
- Overall Footprint of 36" x 14" without Leg Extensions
- Weighs Only 20 LBS.
- Optional Tool Tray
- Nest Pads keep wheelchairs level regardless of frame design and eliminates rocking
- Durable enough for everyday use by DME companies, Nursing Facilities and Hospitals
- Portable Design allows the Safer Stand to easily be carried in delivery vehicles for field service



SAFER AUTOMATIC WHEEL LOCK CLEANING PROCEDURES

The material used in your Safer Automatic Wheelchair Wheel Locks is developed by one of America's top corporations, DuPont. The plastic materials used in the locks include Zytel nylon, a component that is strong, durable and slides easily against itself and metal without lubrication. Even when exposed to water, Zytel will not corrode. Safer Locks also have stainless steel and zinc hardware which allows the locks to be washed by any cleaning method without the risk of rust or corrosion.

SAFER AUTOMATIC WHEEL LOCK WARRANTY

Your Safer Automatic Wheelchair Wheel Locks are warranted to be free from defects in material and workmanship under normal operating conditions for a period of **TWO YEARS** from the date of purchase. Safer Automatic Wheelchair Wheel Locks sole obligation under this warranty will be replacement of the Automatic Wheel Locking device and shipping. This warranty does not cover failure due to abuse, misuse, alterations or improper installation performed by facilities outside of the Safer Automatic Wheelchair Wheel Lock facility.

Keep this book and your sales slip together for future reference. You must provide proof of purchase or installation date for warranty service.

Write down the following information about your Safer Automatic Wheel Lock Kit to better help you obtain assistance or service if you should ever need it. You will need to know your complete wheelchair model and serial number, and the complete locking kit part and serial number. The locking kit part number is located on the box that the kit was shipped in, and the locking kit serial number is on the back of the Lock Pin Assembly.

Dealer Name:

Date of Purchase:

Wheelchair Model Locking Kit Installed on:

Wheelchair Serial Number Locking Kit installed on:

Locking Kit Part Number:

Locking Kit Serial Number:



Manufactured By: United Plastic Molders, Inc.
105 East Rankin Street - Jackson, MS 39201
800-890-5113
Fax: 601-353-8069
www.saferwheelchairs.com

THIS PAGE INTENTIONALLY LEFT BLANK

THIS PAGE INTENTIONALLY LEFT BLANK

